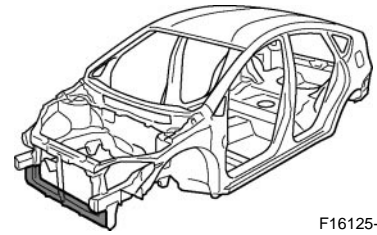
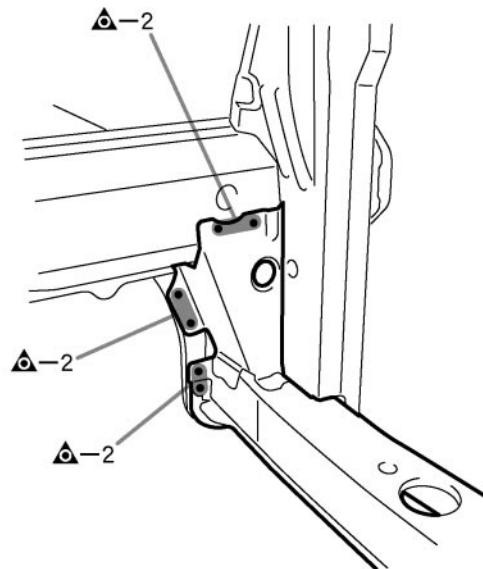
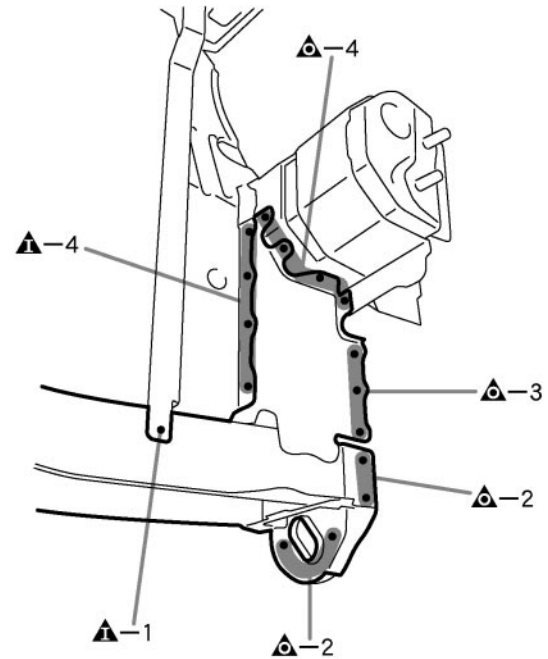
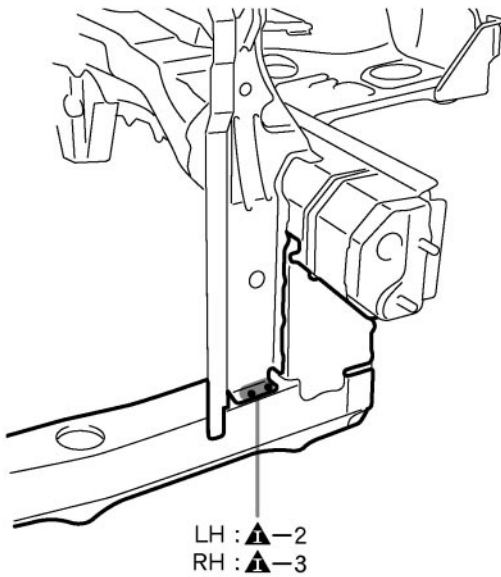

FRONT CROSSMEMBER (ASSY)**REPLACEMENT**

F16125-A

REMOVAL**[RHD]**

F16125

[LHD]

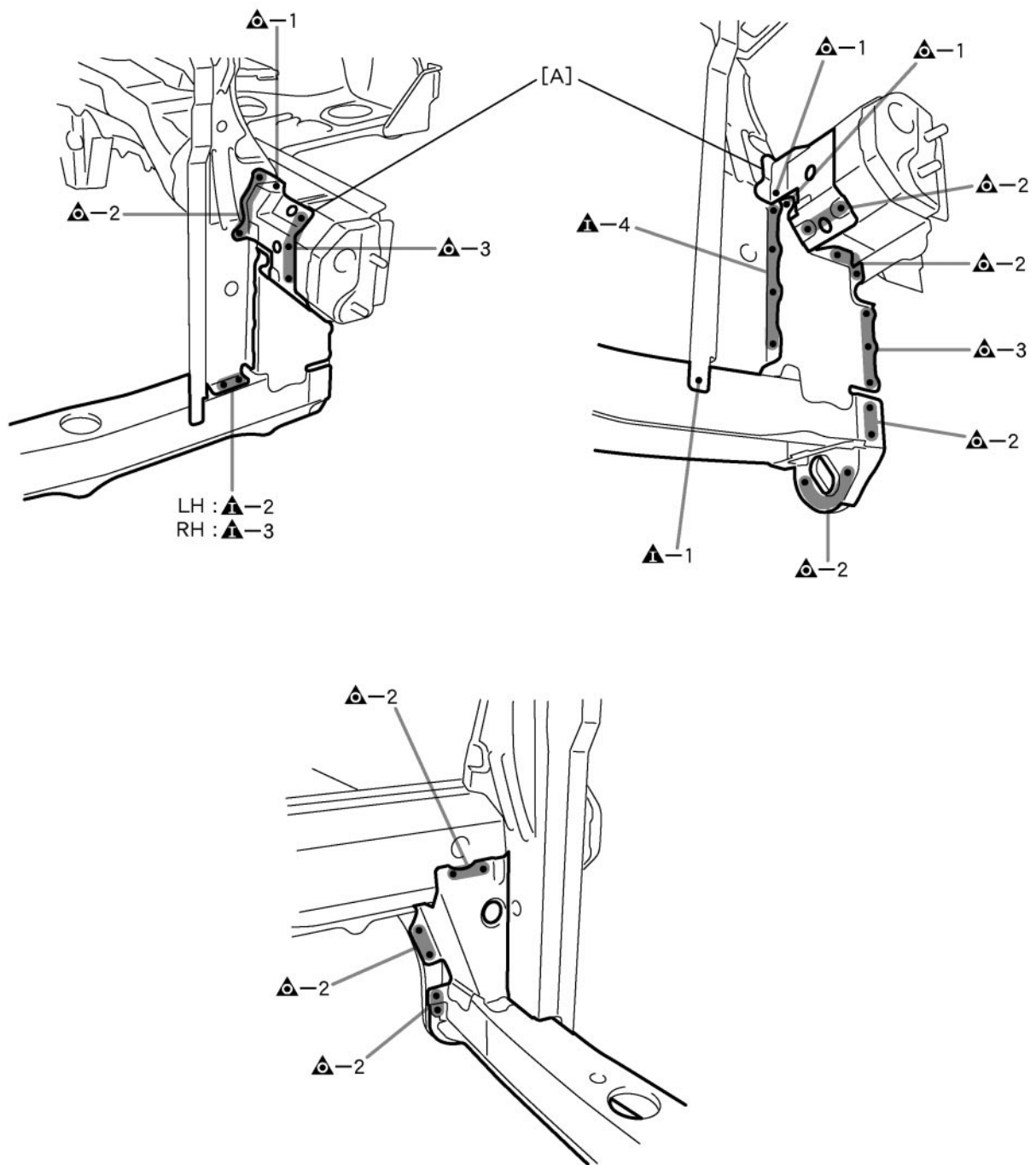

F16126

POINT

1 Remove the [A] at the same time.

PART NAME

[A] Front Sidemember Support

INSTALLATION

- Temporarily install the new parts and measure each part of the new parts in accordance with the body dimension diagram. (See the body dimension diagram)
- Inspect the fitting of the related parts around the new parts before welding. This affects the appearance of the finish.
- After welding, apply the polyurethane foam to the corresponding parts.
- After welding, apply body sealer and under-coating to the corresponding parts.
- After applying the top coat layer, apply anti-rust agent to the inside of the necked section structural weld spots.

[RHD]

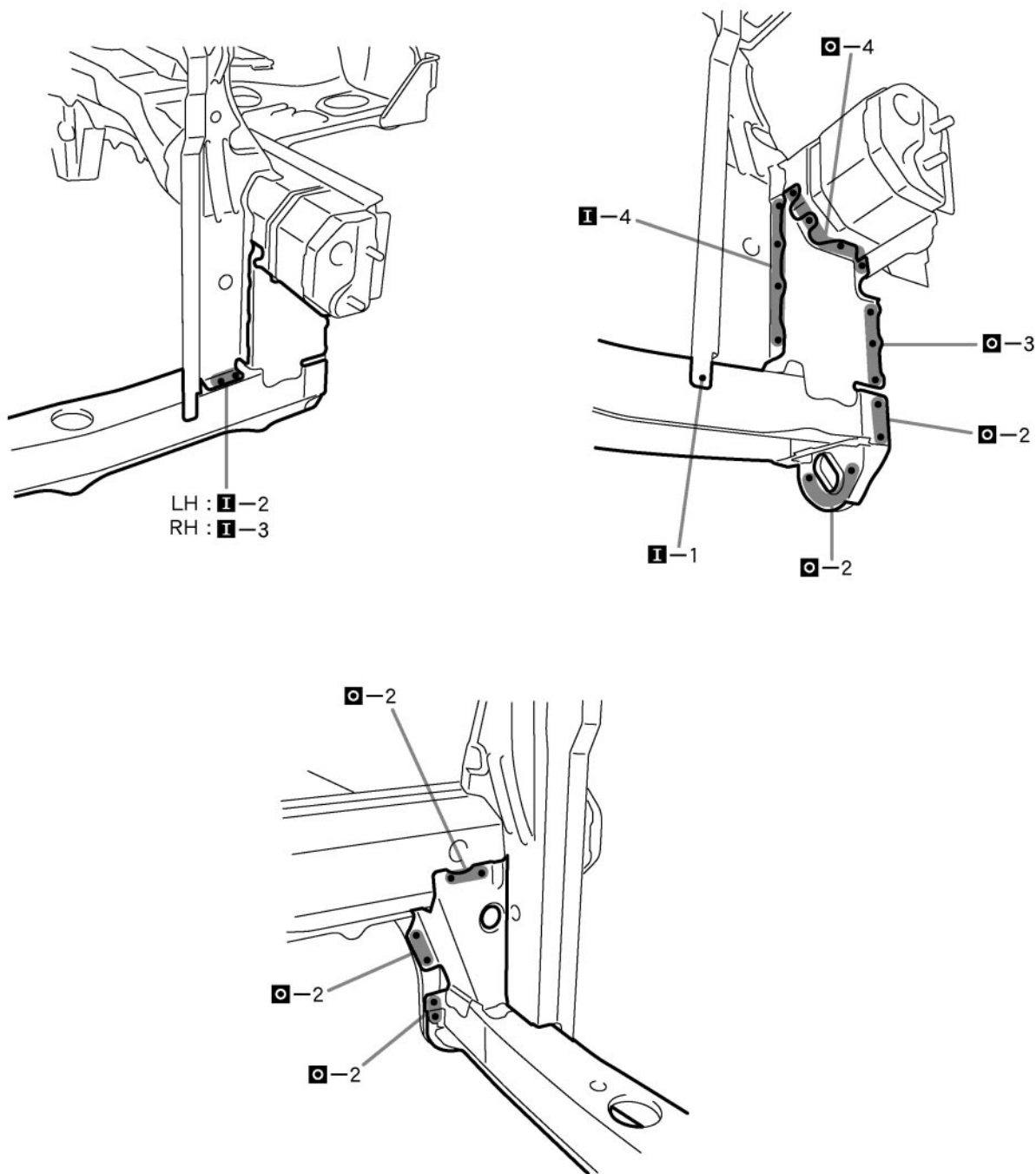

[LHD]

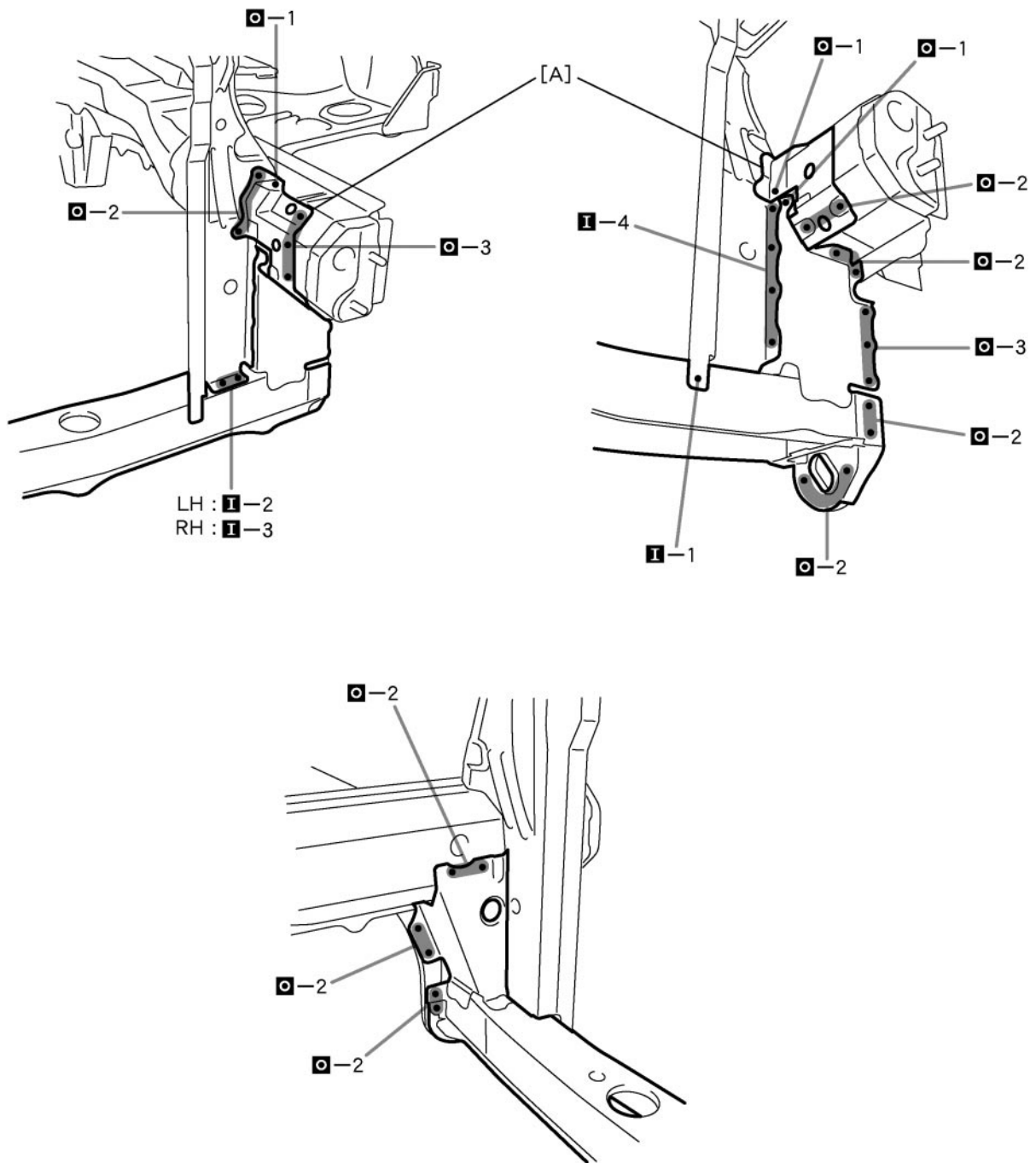

F16128

PART NAME

[A] Front Sidemember Support